

imants[®]

Digging the future

15 cm (6")
Minimal spading

35 cm (14")
Maximum spading

52 cm (20")
Maximum subsoiling
(WX)

36/46/56-Series Heavy Clay

- Time-saving
- Good mixing
- Promotes water balance
- Incorporation of organic material

- Even seedbed
- Quality and robust
- Preserves soil structure
- Lifting Compaction

- Fuel Saving
- Cost-effective
- No plow pan
- All-round machine



Digging
the
future

THE IMANTS PHILOSOPHY

Spading is more than just turning ground

Your land is your wealth. It is the lifeblood of your business. That's why you want to continuously improve your soil. You want to build it up for the future, for your successors. Imants would like to contribute to that future.

More than 60 years of experience with spading machines is something Imants can look back on. From that experience we learned that digging is more than just turning soil. Much more even!

Spading, which mixes organic material with the living topsoil, by working crop residues and green manure into the soil so they can be converted into nutrients. With an Imants spading machine you can also create a seedbed ready to plant in.

As a manufacturer, Imants offers you a solution for any tillage requirement. Whether deep or shallow, active or passive, intensive or extensive, mixing or non-mixing, reversible or not.



Treatment of spading axle

ADVANTAGES OF SPADING

Imants spading machines take care of your soil



Mixing

Depending on the desired result, Imants offers many choices including the 36, 46 or 56 series rotary spading machine. With all series, you can both winterize your heavy clay soil and prepare a seedbed, and this without having to change anything on the machine.

The rotary motion of the spading knife ensures optimal mixing.

Usually, with the 36, 46 or 56 series, the clay lies in smaller chunks because the spading knife pulls the soil loose and then takes it back with it during the rotating movement. The rotating movement of the spading knife ensures optimal mixing. Crop residues, manure, compost or green manure are mixed with the soil over the entire working depth so that they can be quickly broken down or absorbed. The motion of the spade knives fractures and lifts the soil which avoids the creation of a compacted plow pan. Also, the special position of the blades ensures that no smearing occurs. This means that (heavy) precipitation can penetrate the deeper soil layers and replenish the groundwater.



No disturbing layer



Water

The loose structure left behind after digging not only allows water to pass through, but air and roots can also penetrate deeper into the soil. Because spading machines do not form a plow pan in the soil, capillary action remains mostly intact. Thus, the rising groundwater can reach the roots of the plants when they need it.

With an Imants spading machine, the soil can be made prepared for sowing or planting in one operation

During tilling, the soil is mixed, but not completely turned over. With an Imants rotary spader, the soil can be made ready for sowing or planting in 1 operation. By combining operations you not only save time and money but also the soil structure (see combine operations p. 20). All these features ultimately lead to a better yield.



Air



Even seed bed



Versatile



Scan for film explaining 46 Spading Machines roller options.

CONSTRUCTION 36, 46 & 56 SERIES

The construction of the rotary spading machine

The spading machines in these series cultivate the soil by means of spading knives bolted to the axle. In all three series, 4 knives are mounted to each bank. The number of spade banks varies according to the working width.

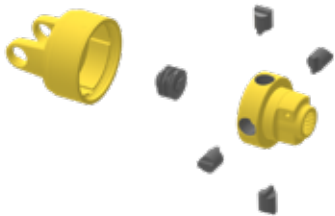

▲ All spading machines are equipped with a cam clutch on the PTO. This provides protection for the driveline.



Various spade blades

Depending on your application, various spade blades can be chosen. All of the blade types are bolted on for ease of replacement.



▲ SPX spade blade suitable for all soil types excl wet clay



▲ VX spading knife suitable for clay soil



▲ SM spading knife suitable for clay soil

DEEPER WORK

Subsoiling, yes or no?

36, 46 & 56 series

The 36, 46 & 56 series spading machines have a minimum working depth of 15 cm (6 in), maximum is about 35 cm (14 in). The spading knives loosen the soil over the entire working width and mix manure, green manure or plant residues through the most biologically active part of the soil.

36, 46 & 56 series with tine legs

The 36, 46 & 56 series spaders can be equipped with depth-adjustable ripper-shanks between the spade banks, which loosen the ground deeper than the spading depth. The shanks ensure that the spader can work with greater ease in hard clay soil. Because of their location between the spade banks, the integrated shanks improve the self cleaning action of the machine. In addition, the shanks break up any existing plow pans that may exist below the spading depth and make sure that roots can penetrate deeper into the soil.



Digging the future

FIXATION

How do you want to leave the land?

Clod breaker

The Imants 36, 46 and 56 series spading machines can be equipped with a clod breaker. This clod rack works like a rake, passing small root-balls through and pushing larger ones down and further reducing them. In this way a fine finish is created



Prisma roller

For heavier soil types in both dry and wet conditions, the self-cleaning prisma roller is recommended for the 36, 46 and 56 series spading machines. This roller breaks up the surface and lightly compresses the soil leaving a firm level seed bed.



Power harrow

As an option, the 36, 46 and 56 series spading machines can be equipped with a lifting device for a power harrow. This power harrow goes straight into the ground. After spading, it reduces the soil even further and prepares a seedbed.



Active Hybrid harrow

The Imants 46 and 56 series spading machines can be equipped with a driven power harrow. This roller presses the coarser top layer and creates a fine and even seedbed. It is the ideal roller for sandy and sandy loam soils.

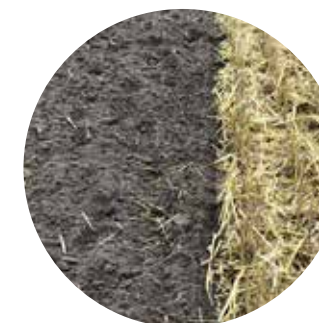

OPTIONS 36 SERIES

Options for the 36 series

To make the 36 series of spading machines fit your farm, you can choose from a number of options. This compact machine can be used on heavy soil in combination with lighter tractors. Moreover, you can not only choose from a number of different rollers, but also a clod rack.

The 36 series spading machines can be customized to meet your individual needs.

In order to be able to remove deeper disturbed layers in 1 pass, this machine can also be equipped with three ripper shanks. These can be added or removed as desired.

Here we show the most common options for the 36 series .
Please contact us for other possibilities

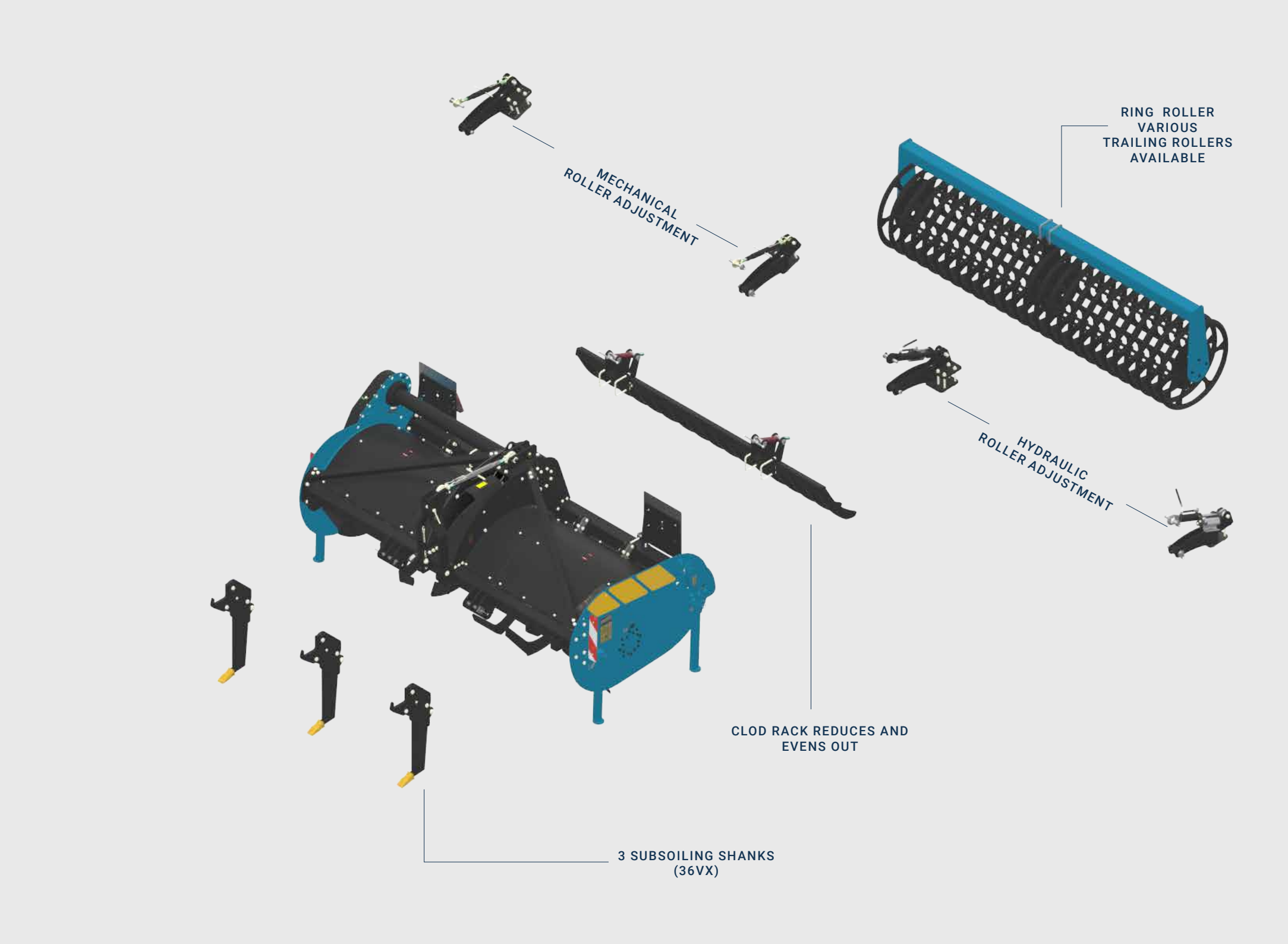

OPTIONS 46 SERIES

Options for the 46 series

To make the 46 series of spading machines fit your farm, you can choose from a number of options. For example, you can choose not only from the rollers listed above, but also from different types of linkage for combining powered and non-powered implements.

The 46 series spading machines can be customized to meet your individual needs.

In order to be able to remove deeper disturbed layers in 1 pass, this machine can also be equipped with three ripper shanks. These can be added or removed as desired.

Here we show the most common options for the 46 series .
Please contact us for other possibilities

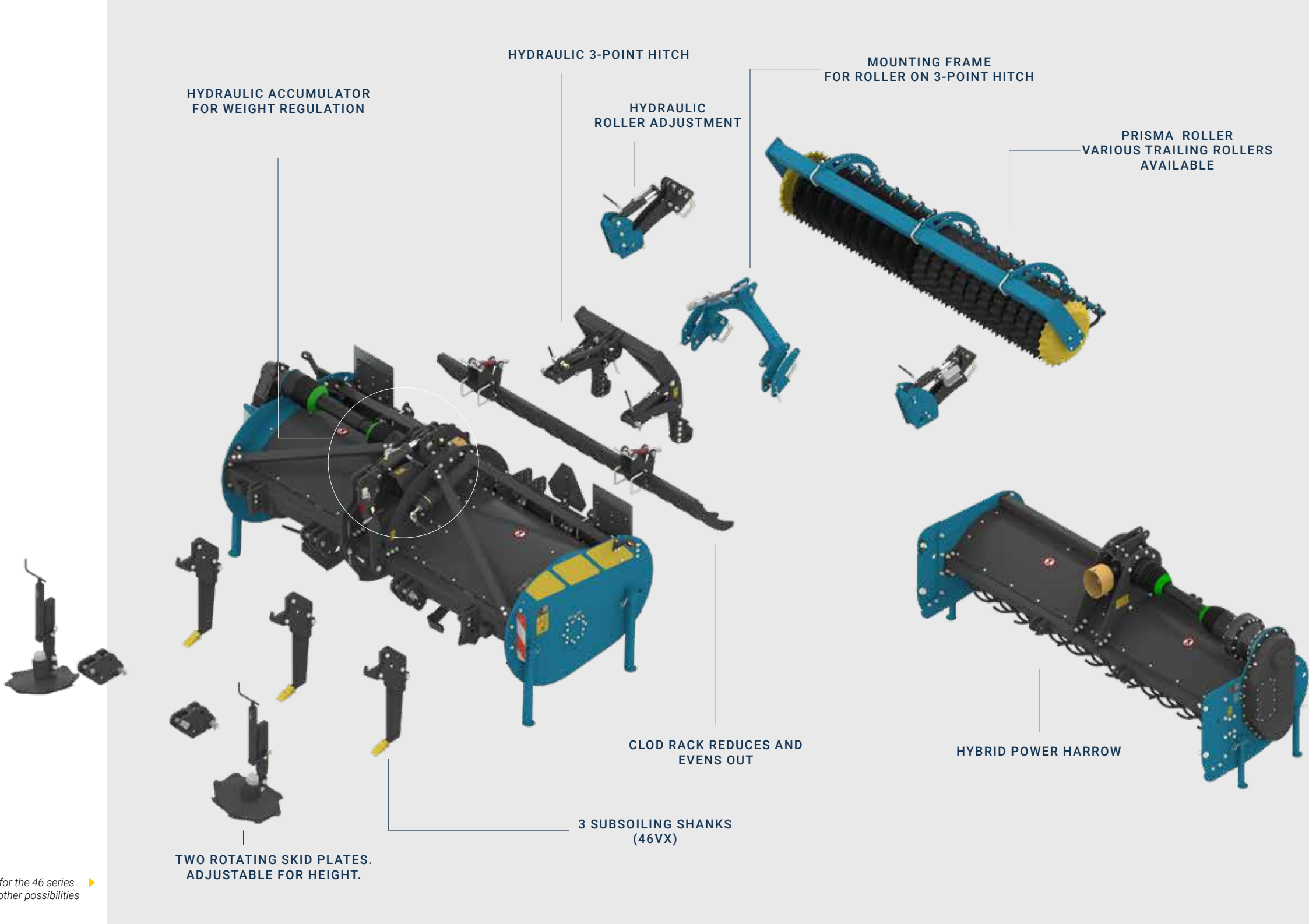

Digging the future



imants[™]
Digging the future

OPTIONS 56 SERIES

Options for the 56 series

The 56 series spading machines can be equipped with a clod breaker to further reduce and level the spaded soil. In addition, you can also choose for different types of trailing rollers depending on the soil type. In order to accommodate seeders or planters, these spading machines can also be fitted with a lifting device for combining driven and non-driven implements.

The 56 series spading machines are adaptable to your specific requirements with a variety of options.

In order to be able to remove deeper compacted layers in one pass when necessary, this machine can also be equipped with three ripper shanks. The shanks can be extended or retracted as desired. If this is a standard requirement, then choose the 56WX with five fixed, built-in ripper shanks as standard.

Here we show the most common options for the 56 series. Please contact us for other possibilities.

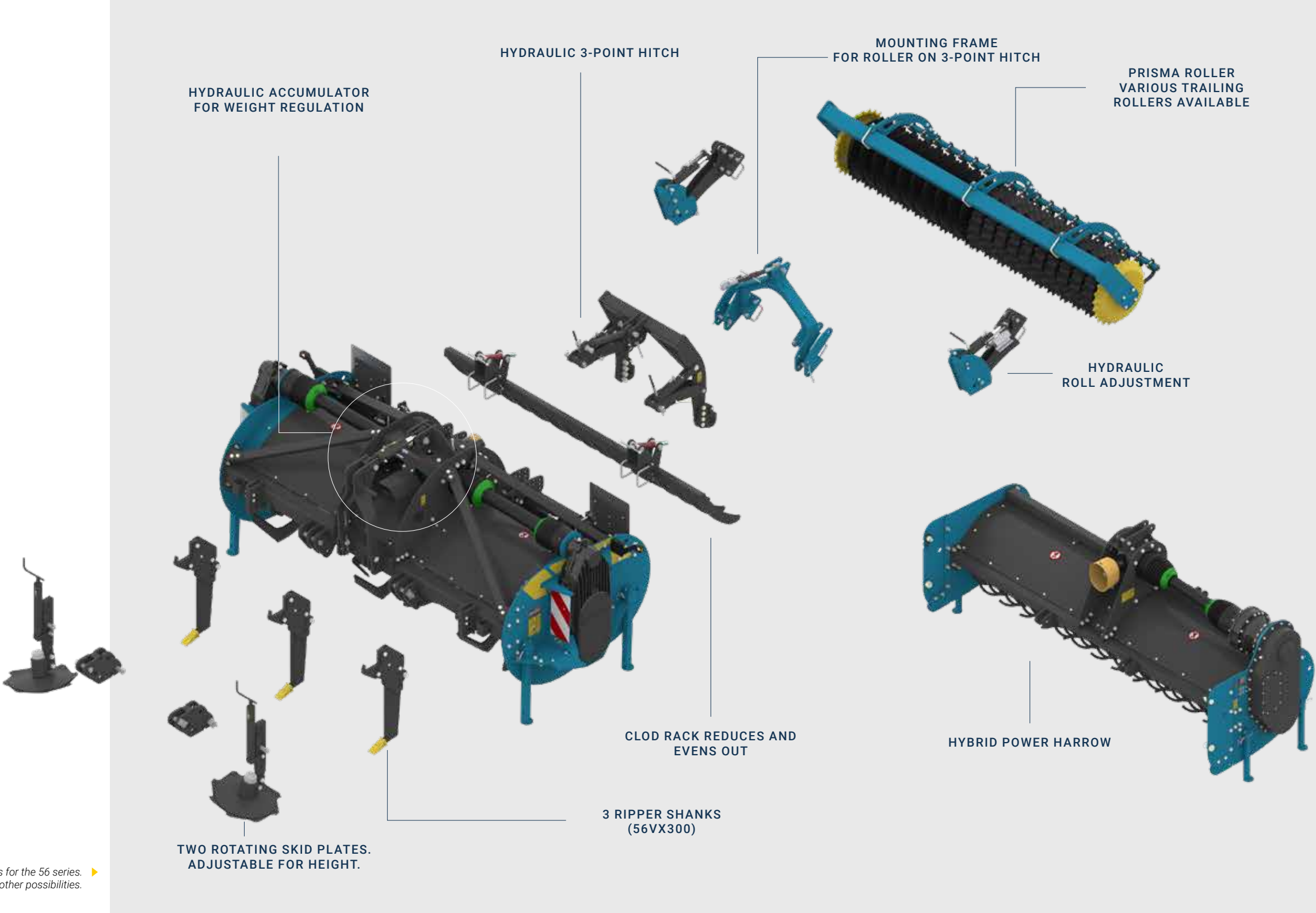

Digging
the
future

OVERVIEW SERIES

36, 46 and 56 series choices and specifications

36 series

Power

95 - 160 hp

Working width

250 or 300 cm

8 or 10 feet



46 series

Power

125 - 225 hp

Working width

300 or 350 cm

10 or 11.5 feet



56 series

Power

> 200 hp

Working width

300 or 350 cm

10 or 11.5 feet



Digging the future

APPLICATIONS

Combining work passes

The 36, 46, 56 and ST series spading machines can be used to prepare the soil for sowing. But the spading machines can also be the heart of combinations to do all the work in one pass. The spader provides primary tillage, loosening and mixing the soil.

Mounting other implements like harrows and seeders, allows a true single pass operation. Combining working passes not only saves money and time, but also reduces stress on the soil structure. Here you can see some possible combinations.

1. 46 Series Solo
2. 56 Series with seeder
3. 46 with power harrow
4. 36 Series Solo
5. 46 Series Solo on corn
6. 56 Series Solo



Type	Working width	Overall width	# blades	Required power (hp)
36VX250	250 cm / 8 ft	277 cm / 9 ft	20	95
36VX300	300 cm / 10 ft	327 cm / 10.5 ft	24	95
46VX300	300 cm / 10 ft	335 cm / 11 ft	24	125
46VX350	350 cm / 11.5 ft	388 cm / 12 ft	28	125
56VX300	300 cm / 10 ft	354 cm / 11.5 ft	24	200
56VX350	350 cm / 11.5 ft	404 cm / 13 ft	28	200
56SX300	300 cm / 10 ft	354 cm / 11.5 ft	36	200
56WX300	350 cm / 11.5 ft	354 cm / 11.5 ft	30	200

Maximum power (hp)	Weight*	Ripper shanks	Other
160	1800 kg / 3968 lbs	Option, 2 pieces	Maximum speed **: 4 km/u or 2.5MPH (1000 rpm) Digging depth: 15-35 cm (7-14in.)
160	2000 kg / 4409 lbs	Option, 3 pieces	
225	2290 kg / 5048 lbs	Option, 3 or 5	Maximum speed **: 5 km/u or 3.1MPH (1000 rpm) Digging depth: 15-35 cm (7-14in.)
225	2320 kg / 5114 lbs	no	
400	2800 kg / 6172 lbs	Option, 3 pieces	Maximum speed **: 5 km/u or 3.1MPH (1000 rpm) Digging depth: 15-35 cm (7-14in.)
400	3250 kg / 7165 lbs	no	
400	2800 kg / 6172 lbs	no	
480	2990 kg / 6591 lbs	5 pieces	

* Above weight is indicative without options and without roll.
** Actual travel speed may vary depending on the application.
ALL machines include: Walterscheid PTO, scrapers on spading axle (only on 36, 46 & 56VX Series). The 56 Series is equipped with oil cooler as standard



Digging the future

Imants BV
Turnhoutseweg 29
5541 NV REUSEL, NL

Phone: +31 (0)497-642433

www.imants.com
info@imants.nl

Dutch CoC. 17154317
VAT No. NL811935371B01

The information in this brochure is subject to change. No rights can be obtained from the specifications.
So always contact your imants representatives for advice.

Dealer:

imants
Digging the future

1001421123